

Bluetooth Interface Unit Type A

1

CAUTION:

- Do not touch inside the controller board compartment. It may cause a machine malfunction or a burn.

Important

- Before manipulating the Bluetooth Interface Unit, touch any metal thing to discharge static electricity. Static electricity thing damage the Bluetooth Interface Unit.
- Do not subject the Bluetooth Interface Unit to physical shocks.

1 Check the contents of the package for the following:

◆ Bluetooth

- Interface Unit

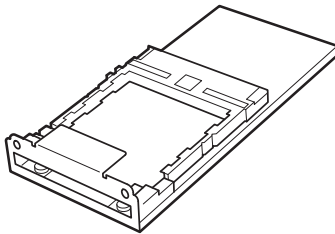

ZHBP410E

- Card

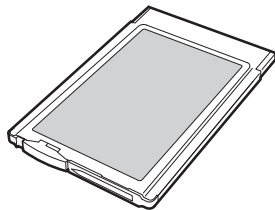

ZHBP510E

- Bluetooth Module

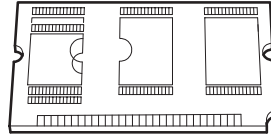

ZHBP620E

- Antenna Cap



ZHBP6921E

2 Turn off the power, and then unplug the power cable.

3 Remove the two screws that fasten the controller board on the back of the printer.

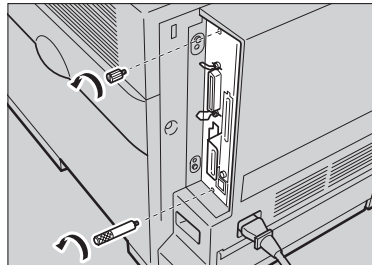

ZHBP680E

The removed screws will be used in step **12** to fasten the controller board.

- 4** While holding the handle, pull out the controller board slowly.

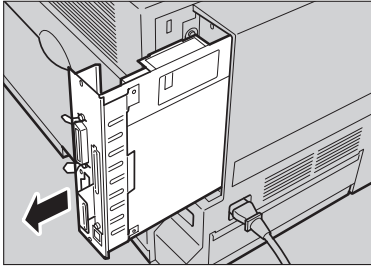

ZHBP020E

- 5** Remove USB2.0 Interface Unit.

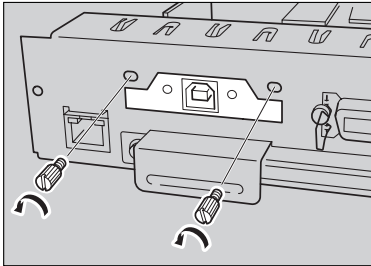

ZHBP840E

Note

- The removed screws will be used in step **7**
- Lift the end of USB2.0 Interface Unit (①), and then remove it from the controller board (②).

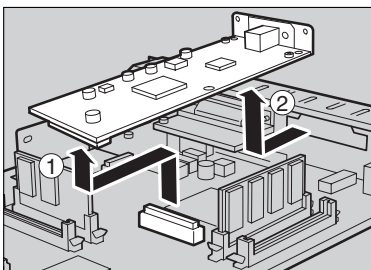

ZHBP450E

- 6** Attach the Bluetooth Interface Unit. Insert the end of the Bluetooth Interface Unit to the opening (①), and then push down until it clicks (②).

1

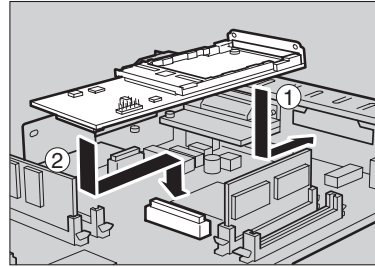

ZHBP190E

Confirm that the Bluetooth Interface Unit is firmly connected to the controller board.

- 7** Fasten the Bluetooth Interface Unit on the controller board using the screws removed in step **5**.

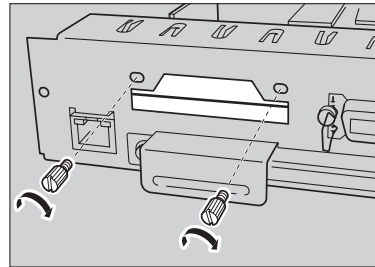

ZHBP200E

- 8** Insert the card slowly into the Bluetooth Interface Unit with its side labeled "INSERT" facing up until it stops.

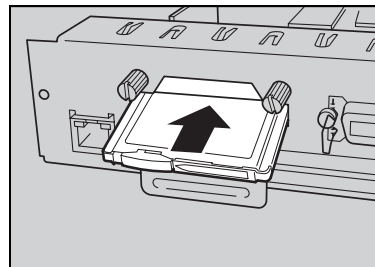

ZHBP530E

Options

9 Press the antenna to extend it.

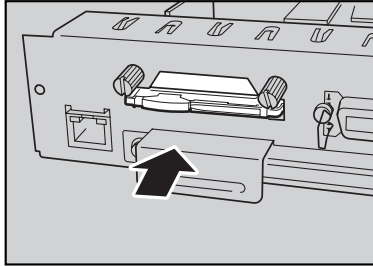

ZHBPAS30E

10 Attach the antenna cap over the antenna.

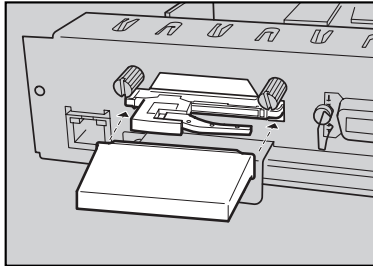

ZHBPA920E

11 Adjust the Bluetooth module to the slot, and then insert vertically.

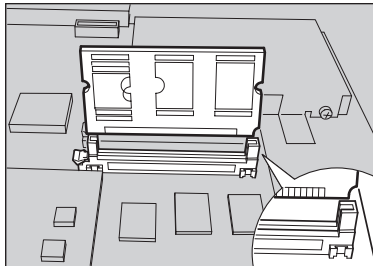

ZHBP540E

12 Align the controller board to the top and bottom rails, and then push in slowly until it stops.

Note

- When installing other options on the controller board, do not close the controller board, but go to the steps for installing the option.

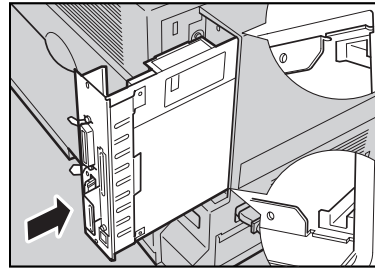

ZHBO550E

Important

- The printer may not work properly if the controller board is not set properly.

13 Fasten the controller board to the printer with the two screws removed in step **3**.

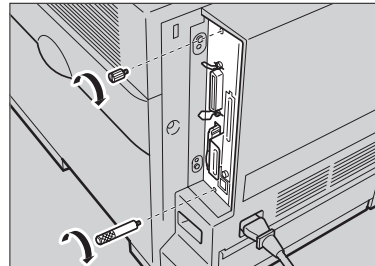

ZHBP560E